

JU310

外形尺寸 · DIMENSIONS(mm)

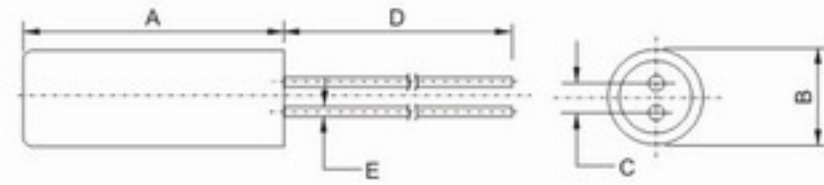
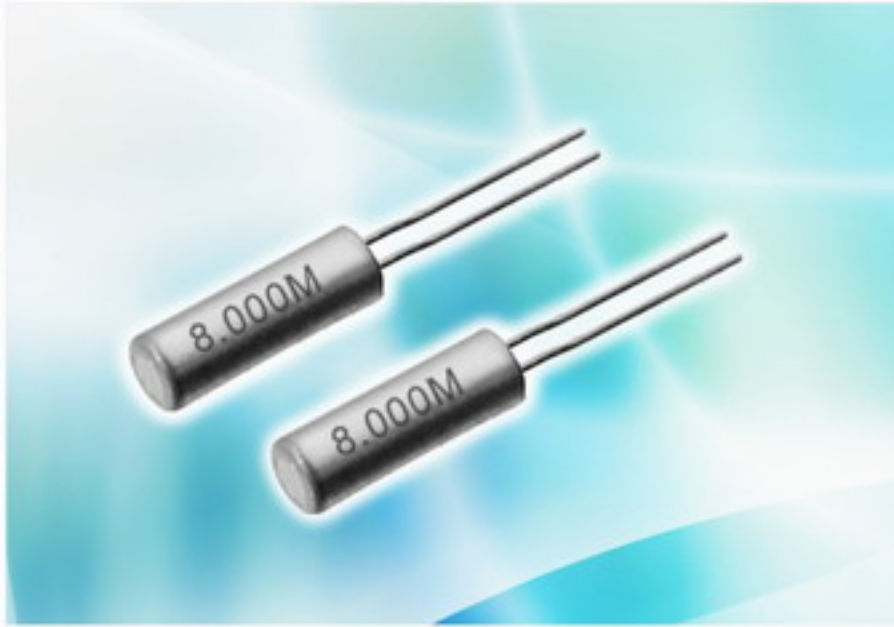

| TYPE | A | D | B | E | C |
|----------------------|---------|---------|---------------|---------------|--------|
| JU 310(ϕ 3x10) | 10.3max | 10.0max | ϕ 3.1max | ϕ 0.3max | 1.2max |

技术参数 · PARAMETERS

| 参 数 | PARAMETER | JU310 |
|------|--|---|
| 频率范围 | Frequency Range (MHz) | 3.0~6.0MHz |
| 振动模式 | Operation mode | See Table 2 |
| 负载电容 | Load Capacitance CL (PF) | 20PF Std. 8 to 32pF Series available |
| 调整频差 | Frequency Tolerance FL (ppm) | ± 20 ppm Std. $\pm 5 \sim \pm 30$ ppm available |
| 温度频差 | Temperature Tolerance TL (ppm) | ± 20 ppm Std. (See Table 3) |
| 工作温度 | Operating Temperature To (°C) | -20°C to +70°C Std. (See Table 3) |
| 存储温度 | Storage Temperature St (°C) | -55°C to +85°C |
| 谐振电阻 | Motional Resistance Rs (Ω) | See table 2 |
| 静态电容 | Shunt Capacitance Co (PF) | 7PF Max. |
| 激励功率 | Drive Level DL (μ W) | 100 μ W Std. 0.01~500 μ W available |
| 绝缘电阻 | Insulation Resistance IR (M Ω) | 500M Ω (DC100 \pm 10V) Min. |
| 年老化率 | Aging (ppm/year) | ± 3 ppm Max. |

TABLE 1

振动模式与谐振电阻 · OPERATION MODE AND RS 温度频差 · TEMPERATURE TOLERANCE

| TYPE FREQUENCY | MODE | JU310 (Ω Max) |
|-------------------|--------------|--------------------------|
| 3.0~3.5MHz | AT FUND | 150 |
| 3.5~4.0MHz | AT FUND | 120 |
| 3.8~4.1MHz | AT FUND | 120 |
| 4.1~5.0MHz | AT FUND | 100 |
| 5.0~6.0MHz | AT FUND | 80 |
| 6.0~8.0MHz | AT FUND | 60 |
| 8.0~10.0MHz | AT FUND | 40 |
| 10.0~12.0MHz | AT FUND | 30 |
| 12.0~28.0MHz | AT FUND | 30 |
| 28.0~33.5MHz | AT FUND | 40 |
| 18.0~35.0MHz | BT FUND | 40 |
| 26.0~40.0MHz | 3rd OVERTONE | 100 |
| 40.0~75.0MHz | 3rd OVERTONE | 80 |

TABLE 2

● RECOMMENDED 推荐使用 AVAILABLE 可用

| CUTTING | TEMP RANGE | FREQUENCY TOLERANCE(ppm) | | | | | | |
|---------|------------|--------------------------|----------|----------|----------|----------|----------|-----------|
| | | ± 5 | ± 10 | ± 15 | ± 20 | ± 30 | ± 50 | ± 100 |
| AT | 0~+50°C | ○ | ○ | ○ | ○ | ○ | ○ | ○ |
| | -10~+60°C | | ○ | ○ | ● | ○ | ○ | ○ |
| | -20~+70°C | | | ○ | ● | ○ | ○ | ○ |
| | -30~+80°C | | | | ● | ○ | ○ | ○ |
| | -40~+85°C | | | | ● | ○ | ○ | ○ |
| BT | -20~+70°C | | | | | | ● | ○ |

TABLE 3